

## April/May 2006 Comment Sheet Summary

*The first project comment sheet was handed out to neighbors at the April 18, 2006 public meeting, along with a postage-paid envelope; was distributed at a Felida Neighborhood Association meeting; and was posted electronically on the project Web page. The deadline for response was May 15, 2006. Additional summarized comments from neighbors not interested in filling out the comment sheet were provided by the Felida Neighborhood Association.*

### **Question #1: What makes a park inviting or accessible to you? How do you want the park to make you feel?**

- A place where I can either walk for exercise or a place where I can play with my daughter/family/friends. Feelings: relaxed, worry free, laughter.
- Looks, and use, fresh look.
- Happy people, colorful equipment, nice native plants and trees – lots of places to sit and talk and walk.
- A nicely mowed grassy area where people can play catch or kick a ball. A place to get exercise, such as climbing on structures or playing tennis. A well-maintained paved walking path where people can take a dog or a baby in a stroller for a peaceful walk. How do I want the park to make me feel? Challenged. Can I throw a Frisbee all the way across the grassy area? Can I make it all the way across the monkeybars? Can I go so high on the swings that I get that dropping sensation in my stomach? Can I run and jump and play so hard that when I'm done all I want to do is come home and rest? My hope is that you will build a park that will "challenge" the kid in all of us.
- Trees, open spaces (fields, etc.), benches and picnic tables. Activity centers such as walking trails and play areas as well (tennis courts, play structures).
- This park would be very inviting to me if there was something to skateboard like a skate park. This would make me feel at home.
- An inviting park has trees, tables and or benches, places to play and walk. Water features nice but not necessary. All things should make one feel relaxed and refreshed.
- Nice monument to [Brad]. Red, white and blue plants by it for us to see that we are fortunate to live in a neighborhood where people volunteer their time to benefit all!
- Need places for rest, play and conversation for 1-88.
- Walking paths, trails. A mix of trees, fields and play equipment. Would be nice to have a play area that is for toddlers.
- Exercise stations – Benches, tables, shade, trees, play stations, several areas for different ages, swings, cans for waste, bathroom.
- Enjoy kids and walk and sit and talk and visit and picnic. Shady areas in summer. Sunny in winter.
- Gazebo for shelter and rest. Tables with benches, trees, wall to sit. Ball area, water features, bricks, Brad's area.
- Well landscaped, well manicured. Feel relaxed and safe.
- Free to play or relax. Go for it!
- Pedestrian crossing by the park. Signs for people to slow down – coming round corner and down on 131<sup>st</sup> (almost got hit several times). I want to feel like I am in Disneyland and have honor.
- The park is inviting if it has a feeling of being safe. Open spaces are important. The park is already conveniently located; it is a "neighborhood" park which makes it automatically accessible. I would be

happy to see the park completed with minor issues and problems. I want to feel the County/City is a partner and not a bureaucratic entity that takes away the good feelings of community accomplishment. I don't want to walk by the park and have bad feelings about how difficult and long the process took just to complete a very minor community project. I'm uncomfortable each time I use the Felida Community Park knowing the City held the residents hostage over cost, time and later a covered patio and picnic table area. With all the taxes we pay we shouldn't have to go begging to local businesses for labor and material to complete a park.

- Well maintained, clean, child friendly.
- As a stakeholder, we would be drawn to an open space dedicated to the retention and preservation of our world's natural environment, particularly in our area which has been beset by a housing and development explosion. The Park should be a place to enjoy family activities in a peaceful and serene atmosphere without worry of intruding upon the activities of others or being intruded upon by them; a place where parents can simultaneously supervise their children at play and seek a moment or two of peaceful relaxation; a place that dissuades, and in fact does not tolerate, raucous or boisterous activity, with particular emphasis on the prohibition of skateboarding, in-line skating and motorized scooter use. With the exception of the children's play area (which, we believe, should **not** include a skateboard facility, irrespective of size), this should be a Park devoid of permanent physical structures such as rest rooms and/or covered picnic shelters – both invite loitering, graffiti and vandalism. Lastly, we have grave concerns regarding parking and traffic on 131<sup>st</sup> and 47<sup>th</sup>. We cannot accept the concept that picnic tables should be clustered or grouped as some have suggested because such a physical arrangement promotes large gatherings that, in turn, generate a need for parking. In-so-far as the Park will not have off-street parking, we are of the firm conviction that any structural arrangement of facilities on the Park property that invites on-street parking will negatively impact the free flow of traffic on both streets, put pedestrians at risk and, equally important, be totally unfair to and penalize adjacent property owners who will have to tolerate the inherent problems of cars obstructing free ingress, egress and the right to quiet enjoyment of their property.
- I want to feel safe and peaceful. It should be an oasis away from my daily obligations – a place to unwind.
- Calm and inviting. A place kids can run and be a kid. A place kids don't have to have a lot of rules where they can make good memories.
- The signs saying that I can skate instead of saying no skating. Great that I have put my thoughts and ideas into something used by all.
- This is for kids, not me. Trees, flowers, bushes, trails, swings, monkey bars, teeter totters, climb rocks, hill with slide, picnic tables, \*benches\*, animal shapes, play structures, restroom (don't want kids relieving themselves in the park or on my property).
- My family lived here for a very long time! You should provide an area with history plaques. "Native" "Farm" "Now" "Future"
- Crawford Park: Pedestrian crosswalks to provide safety. Inviting entrance. Colorful play equipment.
- Happy. Play equipment, walkways, trails, lots of benches and picnic tables, trees, plants, shrubs and flowers. Shade spots, play and quiet areas.
- Restroom, drinking fountain. Perimeter trail, trail through school property connecting to McCann. Tennis court (2), basketball court.
- Open space, walking path, benches for elderly, play structure for children, trees, shrubs, enjoyable, fun, relaxing place to get away from the fast pace of everyday busy life.

**Question #2: Describe how this space will be used 50 years from now. What activities would take place? What are the sounds or smells?**

- People gathering to relax and play. A place/area to honor fallen policemen/firemen.
- That the fresh look is still there, and the activities will make you feel good.

- Newly married as well as nearly retired couples will come to the park to play tennis. Wives who are pregnant will take a stroll around the park's path. Men who are training for an upcoming road race will run a couple blocks out of their way to job through the park because it's a peaceful and shady end to their run. Families with newborns and toddlers will spend hours playing and laughing on the play equipment. Fathers will teach their children how to throw a spiral, catch a pop-fly and hit a top spin lob.
- A meeting place for our community. Safe place for families. Large trees will provide a canopy of shade. [Smell of] freshly cut grass.
- 50 years from now...still green, mature trees and still a place that offers serenity from the bustle of life.
- Need some story (for history) etched in stone or granite.
- There would be many skateboarding activities happening all the time, and most likely be used 50 years now. For example, Burnside Skate Park.
- It will be used more.
- I think this space would still be used by families, kids playing, picnics, people going for walks, etc. I'd love to see big, beautiful shade trees. Some area w/ beautiful gardens, flowers.
- To meet, play and enjoy outdoors.
- By our kids and great grandchildren.
- (My) Kids Space and their kids.
- Need to educate people about sacrifice/Brad's family. Teach respect for law enforcement, clean parks, green spaces. Respect for community, people, fauna, flora, private/public property, "Bambi's" – have deer and herons.
- First, let's assume that (most likely the city) will not have taxed us out of the area. If the Parks department wisely uses the latest tax increase, I will assume there will be children in the park. Balls will be thrown in grassy open spaces. There will be picnicking while children play on the swings, and babies are sleeping on blankets shaded by mature trees. However, if the bureaucrats have their way I suspect there will be low cost, high rise housing on the site. Again, the activities and sounds or smells is pretty much contingent on how the politicians take advantage of the neighborhood. Otherwise, fresh mown grass, flowers and a variety of pollen will permeate the air. Toxic, internal combustion cars will be a memory of times past. I would hope there would be children on tricky bars and sounds of laughter from the swings. It has been my experience that the most simple of toys such as tricky bars, swings and large slides have an enduring and lasting value and use. At your session one little boy made the suggestion of a merry-go-round. Darn good idea. Of course it would out of question to place a merry-go-round in this park, but one of those small whirling, self propelled, jump on and get dizzy machines were great when I was a kid and would be appropriate. I suspect there were several injuries so they have been taken away and substituted with large, obscenely colored, expensive plastic, climb all over equipment.
- Kids playing, sand-lot style baseball games, and families gathering to visit. Sounds – children laughing. Smells??
- Given what appears to indicate exponential growth in human population for the foreseeable future, this Park should be one of many, hopefully, sources of respite from the day-to-day pressures of life; it should provide an island of natural and open landscaping for families to enjoy in peaceful respite. It should have, as a primary goal, a connection with the natural beauty of the Pacific Northwest, its abundant, indigenous trees, flowers and shrubbery. Finally, in 50 years this Park should still provide an oasis of peace and tranquility in a sea of developed property.
- It is a haven for neighborhood children to gather a play in a safe location. A place that fosters their imagination and allows them to interact with the natural world.
- The space would be inviting to people of all ages. Seniors who want to sit on a bench and watch the kids and birds. Teenagers playing basketball, riding their skateboards. Kids playing on a play structure and babies crawling in the grass.
- Kids everywhere – especially with school there.
- Play, relax, walk, sit, visit with neighbors, and enjoy outdoors.

- Kids laughing and playing. Muffled sound of tennis balls being returned. Baskets being shot on the hoops. Smell of freshly cut grass.
- 50 years from now, skate competition will be held here because of the great design and environment.
- Children and family play time! Picnic and walking with kids and animals (dogs). Relax and listen to happy voices and birds away from traffic.

**Question #3: You meet a time-traveling child who lives 100 years in the future. The child thanks you for helping plan the park. What kind of comments from the child would make you most proud?**

- The child would say: What a well-designed park; isn't it neat they remembered policemen/firemen who died on duty; what a well-maintained park!
- How the park made him feel.
- It would make me the most proud to hear the child say, "Thank you for including tennis courts in this park, because without them my brother and I would never have won the state doubles tennis title."
- That we had provided a child a place to discover nature and feel safe to play. Child: "I'm proud of this park and we will work to keep it nice." (our hope)
- Thank you for planning a relaxing green space.
- Memorial for Sgt. [would make me most proud]. Need a spaceship but will have same needs as we do.
- "The park was laid out so beautifully! So glad the early planners put in all these beautiful trees! This park is a mini-oasis! Love the garden areas! Such a pretty spot for a picnic!"
- Having a child [give] thanks for the great fun and experience he or she had skating at this skate park.
- Memorial for the Sheriff's deputy, policeman [would make me most proud].
- They will have better products and technology, but will need open space to put it in.
- The very fact the park still exists and is being used and played on would be a tribute to those who lived and still live in the neighborhood.
- Thank you for protecting this small piece of our natural environment.
- You designed a park that lasted through a century and is timeless.
- A safe, fun place that a child can play without safety issues and they can enjoy being a kid and have good memories of playing with their family and friends.
- Thank you? Maybe preserve this open space for them to play in.
- How much fun they have playing with their friends there.
- Thank you for making this space colorful, safe and special for me to enjoy.
- I love the play equipment and animal shapes, boats, cars and other structures like they have at the Portland Zoo children's area.
- Thank you for Sgt. Crawford's park. I learned to ride my bike on the exterior path. I like the way it connects to the elementary school. If we didn't have that tennis court I don't know if I would have learned to play. Having that restroom and drinking fountain meant I could stay longer at the park.
- The child saying that it's so inventive instead of building houses on the lot. Also saying that the park is the best in the county and all his friends want to move there.
- "This is a fun place to play!" "We love the beautiful trees!"

**Question #4: Below are a few draft Guiding Principles for this park master planning process. These principles will help inform the design decision for the development of this park. What do you think about them?**

- ❖ **Accommodate recreational and open space activities to meet the diverse needs of the neighborhood, now and for the long-term.**
- ❖ **Develop a park that celebrates Sgt. Brad Crawford's life and honors his memory.**
- ❖ **Establish natural areas and incorporate principles of sustainability.**
- ❖ **Address access, security, and adjacent uses.**

❖ **Develop a plan that is financially responsible and viable for the long-term.**

- Walking trails. Volleyball – sand courts. Tennis courts. Grassy areas. Memorial marker/monument. Small play area w/ swings.
- Benches, paths for waling and bicycling.
- Plant dogwood for Brad’s sacrifice.
- The guiding principles are great. Specifically I would hope the park would include: Tennis courts, walking/bike trail, tire swing, irrigated grassy area, monkey bars, large swings, artificial climbing boulders.
- Guiding principles sound reasonable. Honoring this officer’s memory teaches us all another valuable lesson about supporting all members of our community. Thanks for asking for our input!
- Landscaping suggestions – Native and drought tolerate plants. Plus public education about pet responsibilities. Walking trail like Felida Park. Commemorative bricks.
- Benches, tables, shelter, walkways, rocks to climb, off leash dog area, bathroom, drinking fountain, flat area for wheelchairs, monument and plaque with badge for Brad, sheriff car sculpture, lots of trail footage and benches or rocks (flat) to sit on and picnic.
- A skate park would be a great plan that would be used and valued years from now.
- Please make this a great place for all people – young and old. Soon!
- Lots of places to sit.
- Benches, tables, swings, monkey bars, teeter totters, slides, merry-go-round, walkways, overhead bars, climbing steps, bridges, photo boards, and more benches in the sun and in the shade.
- I agree with the draft of the guiding principles. The park bears Sgt. Crawford’s name, so I think the most important thing is that the end result is something he would have been honored to know was associated with him. If he loved children and children’s activities, then let’s be sure that the park is inviting to children and is designed to bring them together. I got back to the idea of the back-stop – a place for father and child to practice together creating everlasting memories for both, and a place for a group of neighborhood kids to come together for a game of ball – timeless.
- Memorial, trees, rose garden, benches, picnic areas, swings, tire swings, chair swings, [can’t read handwriting], slides, [can’t read handwriting], water spigot, potty, garbage cans, dog containment area, bicycle racks, climbing ladders.
- Benches, picnic tables, trails, trees, climbing areas, sculptures w/ animals, water feature, bathroom.
- Suggestions: Provide tennis courts.
- [1<sup>st</sup> bullet]: Do it; [2<sup>nd</sup> bullet]: Yes!!; [3<sup>rd</sup> bullet]: Of course; [4<sup>th</sup> bullet]: Pedestrian crosswalks too; [5<sup>th</sup> bullet]: We will help. Felida Neighborhood organization has great leadership, ample networks in the county and many members that are busy but want to help in many ways and through donations.
- [1<sup>st</sup> bullet]: Given that this Park, at roughly 2.5 acres, falls below the minimum desirable size set by the County at 3 acres, it will be a bit of a challenge to meet both the open space and recreational needs of the neighborhood. However, when one considers the close proximity of Felida Park, at ½ mile, designated as a “Community” park, and the many schools and recreational facilities within short driving distance, the “balance” issue becomes less perplexing and less of a burden on the Park’s limited footprint. The housing boom in Clark County has come at a significant cost to natural habitat. In fact, when the surrounding housing developments were completed, the Park area survived as a bulldozed-over area denuded of trees and natural vegetation. In the long-term, as the surrounding populace matures and children become the exception rather than the rule, the Park should serve the needs of humans seeking solace and peaceful respite. The surrounding neighborhoods do not currently exhibit the characteristics of raucous activity and it stands to reason that the Park’s “personality” should be one compatible with all surrounding homeowners’ rights to the peaceful the quiet enjoyment of their property. It is not unreasonable to suggest that as a Neighborhood Park, each homeowner could envision the Park’s dedication as a nature preserve as an extension of one’s own backyard. This

standard would effectively meet the County's goal to "maintain, preserve, enhance and reinforce the desirable and distinctive characteristics of the community and its individual neighborhoods while strengthening its sense of place."

[2<sup>nd</sup> bullet]: We are aware that there will be a memorial in place on the park grounds and we believe that is a fitting tribute to the life of Sgt. Crawford. Further, we are aware of the importance that young children played in the enjoyment of life Sgt. Crawford experienced. It is, therefore, fitting that a portion of the park be dedicated to children's playground equipment. Most, if not all, of the Neighborhood parks that have been approved by the County in the recent past provide for natural or grassed areas for play as well as areas dedicated to play structures. To that end, we believe it would be appropriate to over-lay Crawford park with the design approved for Little Prairie Neighborhood park and by rotating the Little Prairie design 90 degrees clockwise thus placing the two split entrances on 131<sup>st</sup> Street and the single entrance on the Northern-most boundary for ingress/egress with the school property situated to the Northeast of the park. Given the proximity of surrounding homes, we would additionally suggest that the play area(s) be re-positioned to the Northeast corner of the park to allow for some sense of continuity with the school property as well as provide for the greatest degree of separation from surrounding homes as possible. This positioning would also remove children as far as possible from the hazards posed by increasing traffic on 131<sup>st</sup> Street.

[3<sup>rd</sup> bullet]: The need for natural areas is fundamental and should be a primary requisite in the Master Plan for Crawford Park. In fact, it would be our suggestion that **all** areas, save that destined for a ¼ court basketball court if one has to exist, be designed as natural areas. Natural areas will encourage walking and discourage skateboarding, in-line skating or motorized scooter use, all of which are currently problematic in our neighborhood. We understand the gravel, bark or grass walkways meet ADA requirements. It is our belief that all walkways in the Park be constructed of such materials that will impede and dissuade their use by skateboarder or motorized scooter riders. Both activities are becoming a nuisance in our neighborhood and must not be tolerated or encouraged in the Park. Natural areas, given the Pacific Northwest's climate, are by definition self sustaining and, save periodic mowing, watering or noxious weed removal, require little care. Native deciduous and conifer plantings interspersed throughout the park would provide viable barriers between and shade for the few park benches and picnic tables contemplated for the Park and would be consistent with the precedents set by the Vista Meadows, Little Prairie, Sifton and Erickson Farms Neighborhood Parks, to name a few. Limiting the number and prohibiting the clustering of picnic tables would discourage large gatherings at the Park thus reducing the likelihood of parking and traffic problems on 131<sup>st</sup> and 47<sup>th</sup> both of which are already taking on the personality of major collector or arterial streets.

Given the less-than-optimal size of the Park, it is difficult, if not impossible, to argue that it could support tennis court(s) and/or ½ court basketball court(s) as some have suggested. Those activities are adequately and effectively provided for in the nearby (within ½ mile) Felida Community Park and by school facilities in the community. Further, in a Neighborhood Park, those uses are not compatible with the generally accepted standard of providing "breathing space, visual and psychological relief and solitude, and the needs of the community residents."

[4<sup>th</sup> bullet]: Access off 131<sup>st</sup> Street is already problematic. Currently the street is without stop signage at the East/West intersection with 47<sup>th</sup> Ave. Given the historical residential growth of the past few years and development contemplated for the area in the near to intermediate term, traffic on both streets can only increase. Not only is 131<sup>st</sup> becoming a major connector/collector for surrounding subdivisions, it is also a major school bus route. Any activity contemplated for the Park that would encourage automobile use and could create parking problems on 131<sup>st</sup> or 47<sup>th</sup> should be avoided at all costs. We would seriously advise against permanent structures on the Park grounds such as covered picnic areas and are

adamantly opposed to any form of restroom facility. Both are “vandalism magnets” and offer areas for loitering. With the exception of a portion of the Northern boundary, all adjacent uses are residential and the right to peaceful enjoyment of those properties is fundamental and should be of primary concern. Thus, permanent man-made structures, any type of lighting or any other Park facility that invites or promotes large gatherings, with the associated use of automobiles, should be avoided at all costs. This Neighborhood Park must not end up being a penalty to surrounding property owners because of the proximity of their property to the Park.

[5<sup>th</sup> bullet]: Lastly, if left alone, natural landscaping, grass, gravel and bark chips do not require much in the way of maintenance. Therefore, budgeting will be much more effective in terms of cost containment than that associated with Community or larger parks.

- Focus on the natural element. Soft trails and natural stone benches in strategic places. Include a small amphitheater for imaginative play or a community gathering. Trees and play structure for toddlers → tweens. Open grass for pick up games.
- I like the above [principles], but specifics should include play structure, a basketball hoop, possibly soccer net and an area for skateboarding if possible. We need to make sure teens have something constructive to do at the park so they will take pride in the park and will maintain it. I have small kids, but kids grow up quickly, so all ages should enjoy the park.
- Lots and lots!!! Will need rest after walking there. Benches – 15-20. Tables – 10-12.
- I think celebrating Brad Crawford is great and all, but it’s supposed to raise spirits not bring you down. You don’t want to have to think about Crawford’s [death] when you’re having fun. Open space is good, but Felida Park already has that and less equipment.
- We want to donate trees to the Felida Community Board to plant by the Board. Dogwood for Crawford.
- Sgt. Crawford loved life. He enjoyed sports and seeing his kids actively engaged. The name is great, he would have been embarrassed just to see that. But he would not want some quiet memorial set aside. He would rather have a tennis court, basketball court, restrooms, drinking fountain where kids enjoy life, have fun, learn sports.
- [2<sup>nd</sup> Bullet] #1. This is priority, a memorial park. The park should reflect the age and needs of the children who will always play and gather for fun.

#### **Other Neighbor Comments Provided in Summary Form by the Felida Neighborhood Association:**

- Install bricks for engraving.
- Include a rose garden and lots of benches.
- Have special planting areas next to nice walkways.
- Have a vegetable garden area – have the school district sponsor it and encourage kids to plant and harvest it for the food bank.
- Include a fenced off-leash area for dogs.
- Include dog waste containers.
- Include trash cans.
- Include a bathroom – at least one stall.
- Don’t include a bathroom.
- Include a drinking fountain.
- Include a gazebo similar to the one in Ashley Heights and Fort Vancouver.
- Have benches in the shape of animals similar to the ones in the play area at the Vancouver Mall.
- Include picnic tables, but not ugly ones like at Felida Park (round, concrete, composite, or stone).
- In the memorial area include:
  - Statue of Sgt. Crawford
  - Statue of Sgt. Crawford with a child that he reaches out to
  - Statue of Sgt. Crawford with kids

- Statue of Sgt. Crawford with people
- Plaques on “sitting walls”
- Depict different scenes from his life
- Include a Sheriff’s badge on the ground in front of a statue or within a memorial area
- Include a large Sheriff’s badge inlay in the middle of the memorial area that should have engraved bricks and benches to sit on
- Include a memorial area surrounded by natural rocks to sit on

## Neighbor Drawings Submitted with Comment Forms

Describe how this space will be used 50 years from now. What activities would take place? What are the sounds or smells?

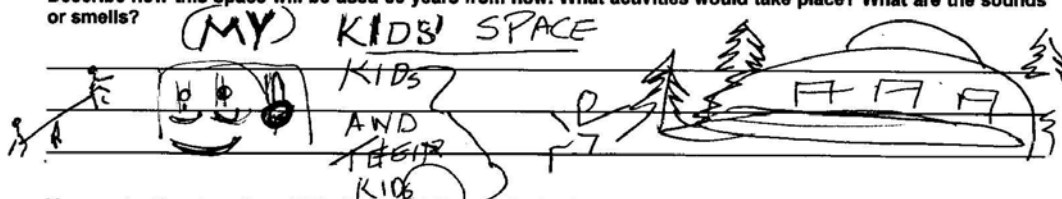

You meet a time-traveling child who lives 100 years in the future. The child thanks you for helping plan the park. What kind of comment(s) from the child would make you most proud?

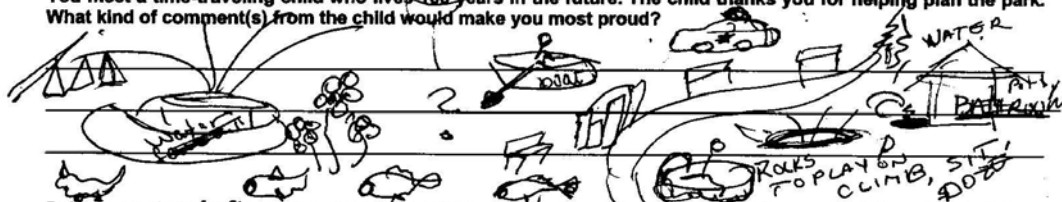

Below are a few **draft** Guiding Principles for this park master planning process. These principles will help inform the design decisions for the development of this park. What do you think about them?

**DRAFT Guiding Principles:**

- Accommodate recreational and open space activities to meet the diverse needs of the neighborhood, now and for the long-term.
- Develop a park that celebrates Sgt. Brad Crawford's life and honors his memory.
- Establish natural areas and incorporate principles of sustainability.
- Address access, security, and adjacent uses
- Develop a plan that is financially responsible and viable for the long-term.

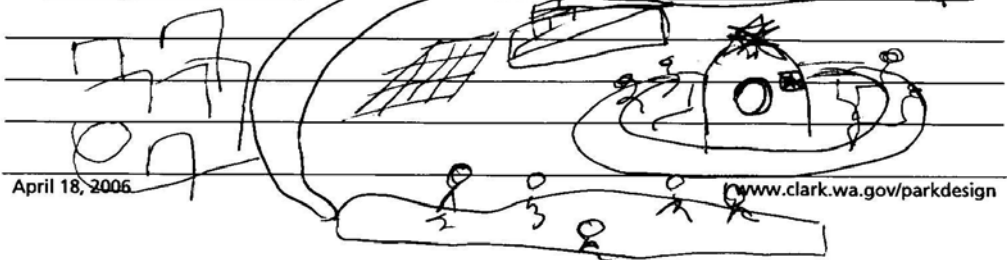

April 18, 2006

[www.clark.wa.gov/parkdesign](http://www.clark.wa.gov/parkdesign)

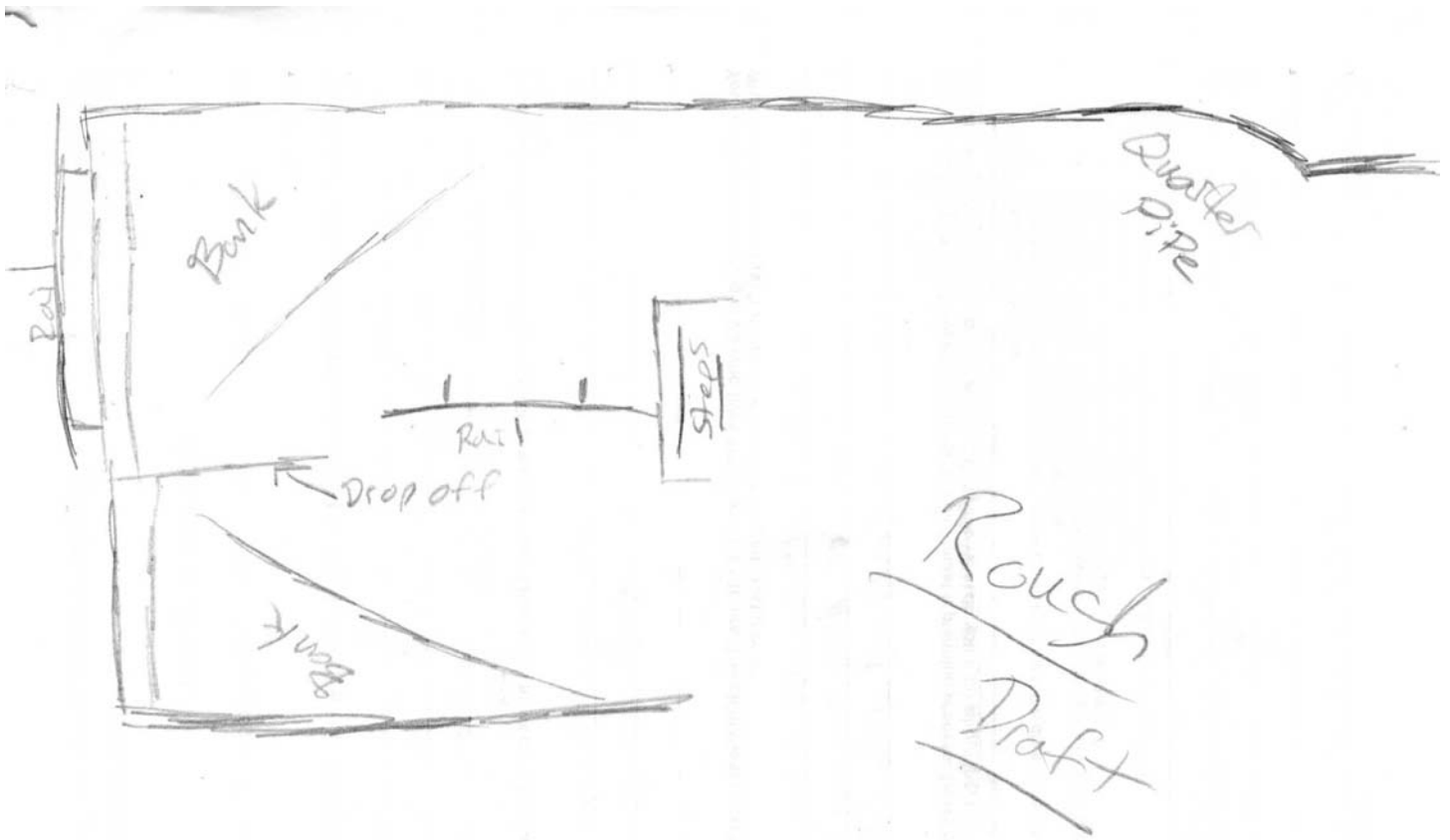

*(Proposed skate park drawing.)*

END